

Stainless Steel Multi-Grip Blind Rivet

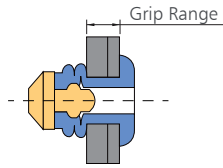

Stainless Steel Multi-grip Blind Rivet

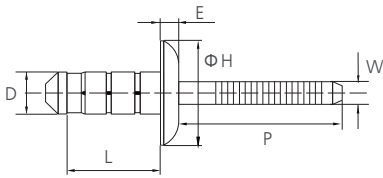

Body	304 Stainless Steel
Mandrel	304 Stainless Steel
Finish	Polished

D	Part Number	L [+1/-0]	Grip Range	H	E (Max)	Drill	P (Min)	W (Max)	Shear [N] (Min)	Tensile [N] (Min)
3.2 +0.08 -0.15	BBMG32080	8.00	1.0-4.0	6.70	1.3	3.3-3.4	27	2.25	1700	2000
	BBMG32100	10.00	2.5-6.0							
	BBMG32120	12.00	1.5-8.0							
	BBMG32140	14.00	3.5-9.5							
	BBMG32160	16.00	5.5-11.5							
4.0 +0.08 -0.15	BBMG40080	8.00	1.0-3.5	8.40	1.70	4.10-4.20	27	2.85	2700	3400
	BBMG40100	10.00	1.5-5.0							
	BBMG40120	12.00	3.5-7.0							
	BBMG40140	14.00	1.5-9.0							
	BBMG40160	16.00	3.5-11.0							
	BBMG40180	18.00	5.5-12.5							
	BBMG40200	20.00	7.5-14.5							
4.8 +0.08 -0.15	BBMG48100	10.00	1.5-4.5	10.10	2.00	4.90-5.00	27	3.35	4000	4500
	BBMG48120	12.00	2.0-6.5							
	BBMG48140	14.00	3.0-8.5							
	BBMG48160	16.00	3.0-10.5							
	BBMG48180	18.00	5.0-12.5							
	BBMG48200	20.00	7.0-14.5							
	BBMG48220	22.00	9.0-16.5							
	BBMG48250	25.00	11.0-19.0							
	BBMG48270	27.00	13.0-21.0							
	BBMG48300	30.00	16.0-24.0							
	6.4 +0.08 -0.15	BBMG64125	12.50							
BBMG64145		14.50	1.5-7.5							
BBMG64165		16.50	2.0-9.0							
BBMG64185		18.50	4.0-11.0							
BBMG64205		20.50	5.5-12.5							
BBMG64255		25.50	10.5-17.5							

Stainless Steel Now-Lock Blind Rivet



Stainless Steel Now-Lock Blind Rivet

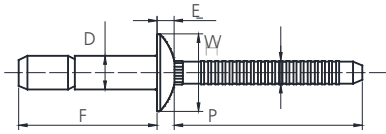

Dome Head

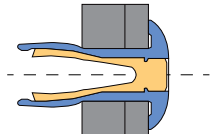

Grip Range

Material	Body	304 Stainless Steel
	Mandrel	304/302 Stainless Steel
Finish	Body	Polished
	Mandrel	Polished

*IPX-7 Watertightness Approved!

No.	Part Number	Size	Art. Code	D	E (Max)	F (Max)	H (Max)	P (Min)	W (Max)	Hole Dia	Grip Range	Tensile ref.	Shear ref.	Breaking Load (Max)	Retention load (Min)
1	BBN48100	4.8x10	BBN0604	Φ4.8	2.2	18.2	Φ10.2	27	3.1	Φ4.9 ~ Φ5.1	1.6 ~ 6.9	4800N	6000N	6500N	445N
2	BBN48140	4.8x14	BBN0607			24.6					1.6 ~ 11.1				
3	BBN64140	6.4x14	BBN0806	Φ6.4	3.2	25.3	Φ13.5	27	4.1	Φ6.7 ~ Φ6.9	2.0 ~ 9.5	8010N	10500N	12000N	890N
4	BBN64190	6.4x19	BBN0810			35.6					2.0 ~ 15.9				

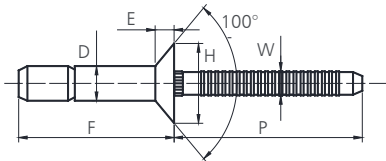

CSK Head

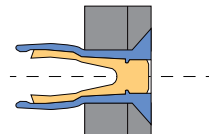

Grip Range

Material	Body	304 Stainless Steel
	Mandrel	304/302 Stainless Steel
Finish	Body	Polished
	Mandrel	Polished

*IPX-7 Watertightness Approved!

No.	Part Number	Size	Art. Code	D	E (Max)	F (Max)	H (Max)	P (Min)	W (Max)	Hole Dia	Grip Range	Tensile ref.	Shear ref.	Breaking Load (Max)	Retention load (Min)
1	BBNC48120	4.8x12	BBNC0606	Φ4.8	2.2	20.2	Φ9.2	27	3.1	Φ4.9 ~ Φ5.1	3.2 ~ 8.4	4800N	6000N	6500N	445N
2	BBNC48160	4.8x16	/			26.5					3.2 ~ 12.7				
3	BBNC64160	6.4x16	BBNC0808	Φ6.4	2.4	28.3	Φ11.4	27	4.1	Φ6.7 ~ Φ6.9	4.3 ~ 12.1	8010N	10500N	12000N	890N
4	BBNC64220	6.4x22	/			38.5					4.3 ~ 17.5				

Stainless Steel Uni-Grip Blind Rivet

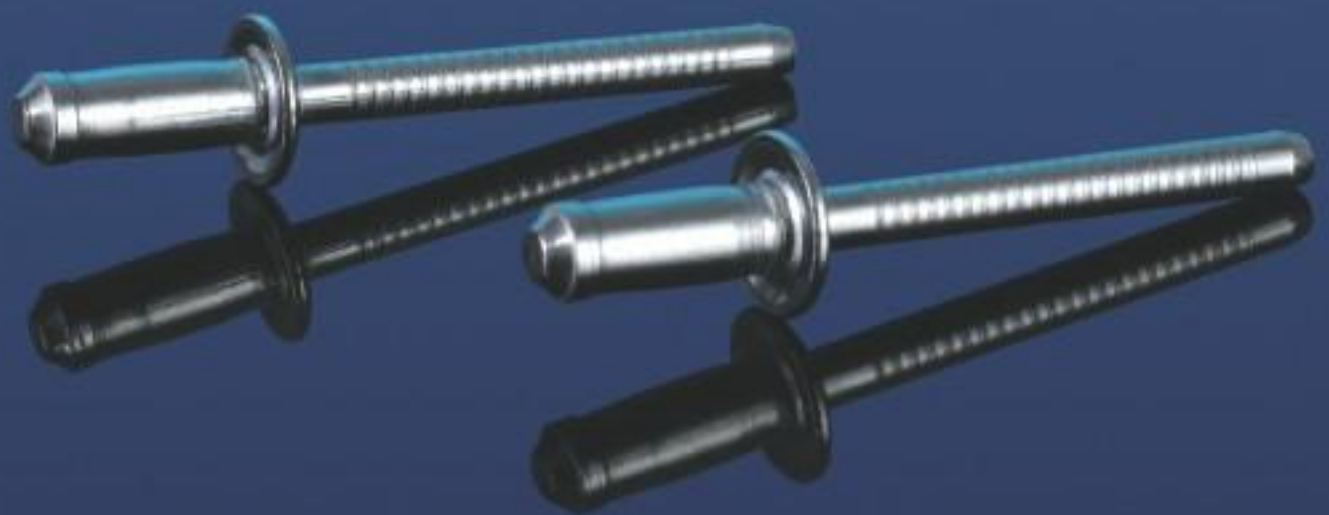

Stainless Steel Uni-grip Blind Rivet

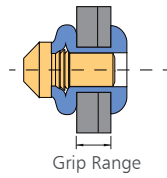
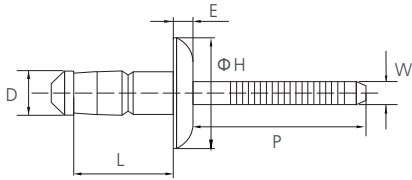

Body	304 Stainless Steel
Mandrel	304 Stainless Steel
Finish	Polished

D	Part Number	Art. Code	L [+1/-0]	Grip Range	H	E (Max)	Drill	P (Min)	W (Max)	Shear [N] (Min)	Tensile [N] (Min)
3.2 +0.08 -0.15	BBPMG32065	BBPMG-0408	6.5	1.0-3.0	5.5-6.6	1.2	3.3-3.4	27	2.15	1600	1600
	BBPMG32080	/	8.0	2.0-4.0						2000	
	BBPMG32092	BBPMG-0411	9.2	3.0-5.0							
	BBPMG32115	BBPMG-0414	11.5	5.0-7.0							
4.0 +0.08 -0.15	BBPMG40075	BBPMG-0509	7.5	1.0-3.0	7.3-8.3	1.6	4.1-4.2	27	2.65	2800	4000
	BBPMG40095	BBPMG-0512	9.5	3.0-5.0							
	BBPMG40125	BBPMG-0516	12.5	5.0-7.0							
	BBPMG40140	/	14.0	5.0-8.0						5200	
	BBPMG40150	/	15.0	8.0-10.0							
	BBPMG40160	/	16.0	9.0-11.0							
4.8 +0.08 -0.15	BBPMG48100	BBPMG-0611	10.0	1.5-3.5	9.0-10.0	1.7	4.9-5.0	27	3.25	4200	5000
	BBPMG48120	BBPMG-0614	12.0	3.5-6.0							
	BBPMG48143	BBPMG-0618	14.3	6.0-8.5							
	BBPMG48160	BBPMG-0619	16.0	7.0-10.0						5500	
	BBPMG48185	/	18.5	6.5-13.0							
	BBPMG48200	/	20.0	11.5-14.0							
	BBPMG48250	/	25.0	16.5-20.0							
6.0 +0.08 -0.15	BBPMG60100	BBPMG-6010	10.0	1.5-4.0	11.0-12.6	2.2	6.1-6.2	31	4.20	7800	6200
	BBPMG60130	BBPMG-6013	13.0	3.0-6.0							
	BBPMG60160	BBPMG-6016	16.0	6.0-9.0						9500	
	BBPMG60190	BBPMG-6019	19.0	9.0-12.0							

304/420 Sealed Type Blind Rivet

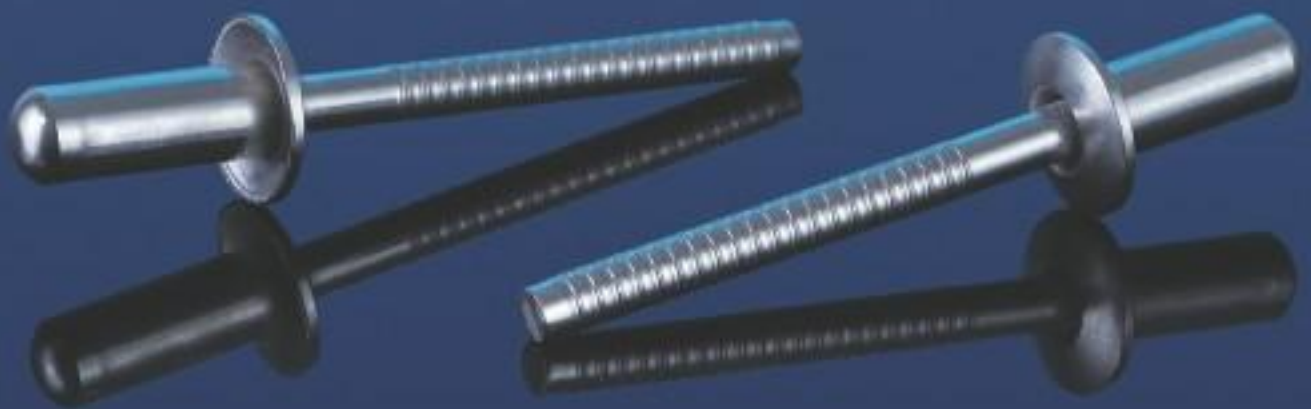

304/420 Sealed Type Blind Rivet

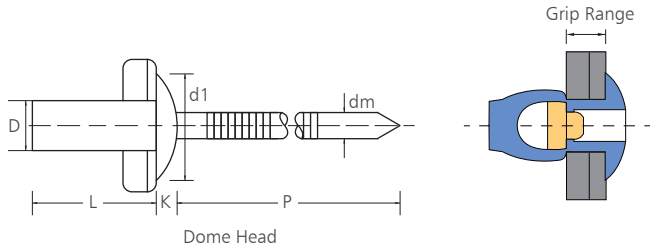

Body	304 Stainless Steel
Mandrel	420 Stainless Steel
Finish	Polished

D	Part Number	L [+1/-0]	Grip Range	d1	K (Max)	Drill	P (Min)	dm (Max)	Shear [N] (Min)	Tensile [N] (Min)
3.2 +0.08 -0.15	BBF-S32060	6.0	0.5- 1.5	5.8-6.7	1.3	3.3-3.4	25	2.05	2000	2200
	BBF-S32080	8.0	1.5- 3.0							
	BBF-S32095	9.5	3.0- 4.5							
	BBF-S32120	12.0	5.0- 6.5							
	BBF-S32140	14.0	6.5- 8.0							
4.0 +0.08 -0.15	BBF-S40060	6.0	0.5- 1.5	6.9-8.4	1.7	4.1-4.2	27	2.50	3000	3500
	BBF-S40080	8.0	1.5- 3.0							
	BBF-S40100	10.0	3.0- 5.0							
	BBF-S40120	12.0	5.0- 6.5							
	BBF-S40140	14.0	6.5- 8.0							
	BBF-S40160	16.0	8.0- 10.0							
4.8 +0.08 -0.15	BBF-S48080	8.0	0.5- 3.0	8.3-10.1	2.0	4.9-5.0	27	3.05	4000	4400
	BBF-S48095	9.5	3.0- 5.0							
	BBF-S48120	12.0	5.0- 6.5							
	BBF-S48140	14.0	5.0- 7.5							
	BBF-S48160	16.0	6.5- 9.0							
	BBF-S48180	18.0	8.0- 10.5							
	BBF-S48200	20.0	9.0- 12.0							
6.4 +0.08 -0.15	BBF-S64120	12.0	1.5- 6.5	11.6-13.4	2.7	6.56.6	27	3.95	6000	8000
	BBF-S64160	16.0	6.5- 8.0							
	BBF-S64180	18.0	8.0- 10.0							
	BBF-S64200	20.0	8.0- 12.0							
	BBF-S64250	25.0	12.0- 17.0							

Aluminum Mono-Lock Blind Rivet

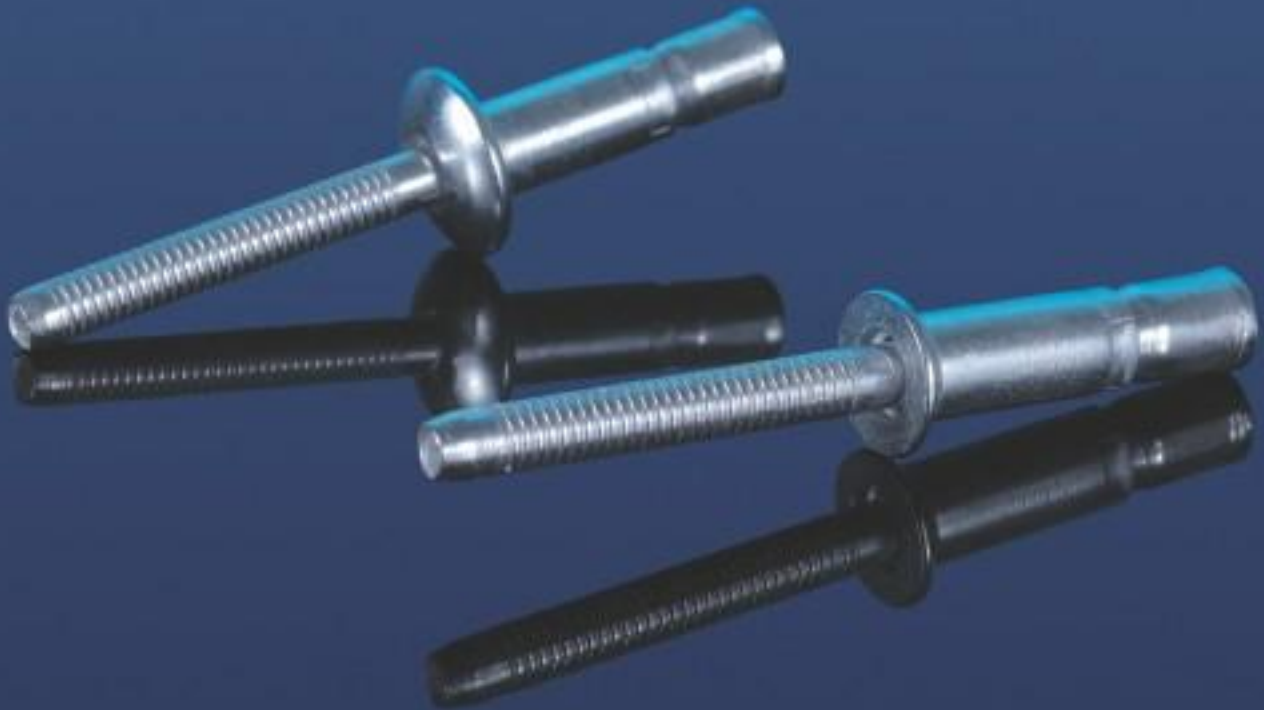

Aluminum Mono-Lock Blind Rivet

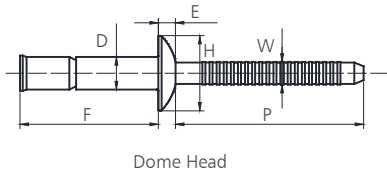

Dome Head

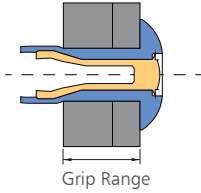

Grip Range

Material	Body	Aluminum
	Mandrel	Aluminum
Finish	Body	Natural
	Mandrel	Natural

*IPX-7 Watertightness Approved!

No.	Part Number	Size	Art. Code	D	E (Max)	F (Max)	H (Max)	P (Min)	W (Max)	Hole Dia	Grip Range	Tensile ref.	Shear ref.	Breaking Load (Max)	Retention load (Min)
1	AAM-48100	4.8×10	AAM-0613	Φ4.70 - Φ4.88	2.1	18.2	Φ10.1	27	3.1	Φ4.9 ~ Φ5.1	1.6 ~ 6.9	2220N	3000N	4000N	250N
2	AAM-48140	4.8×14	AAM-0617			24.5					1.6 ~ 11.0				
3	AAM-64140	6.4×14	AAM-0817	Φ6.40 - Φ6.58	2.9	23.7	Φ13.4	27	4.1	Φ6.7 ~ Φ7.0	2.1 ~ 9.5	4220N	6000N	6800N	550N
4	AAM-64190	6.4×19	AAM-0824			33.0					2.1 ~ 15.8				

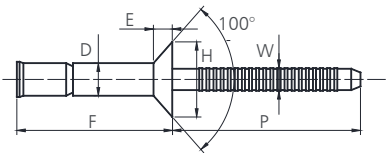

CSK Head

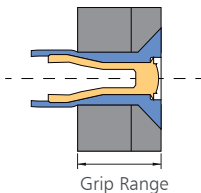

Grip Range

Material	Body	Aluminum
	Mandrel	Aluminum
Finish	Body	Natural
	Mandrel	Natural

*IPX-7 Watertightness Approved!

No.	Part Number	Size	Art. Code	D	E (Max)	F (Max)	H (Max)	P (Min)	W (Max)	Hole Dia	Grip Range	Tensile ref.	Shear ref.	Breaking Load (Max)	Retention load (Min)
1	AAMC-48120	4.8×12	AAMC-0615	Φ4.70 - Φ4.88	2.2	20	Φ8.8	27	3.1	Φ4.9 ~ Φ5.1	3.2 ~ 8.4	2110N	2890N	4000N	250N
2	AAMC-48160	4.8×16	AAMC-0619			26.5					3.2 ~ 12.2				
3	AAMC-64160	6.4×16	AAMC-0821	Φ6.40 - Φ6.58	2.4	26.3	Φ10.1	27	4.1	Φ6.7 ~ Φ7.0	3.2 ~ 12.1	4220N	6000N	6800N	550N
4	AAMC-64220	6.4×22	/			34.5					3.2 ~ 16.0				

Aluminum Now-Lock Blind Rivet

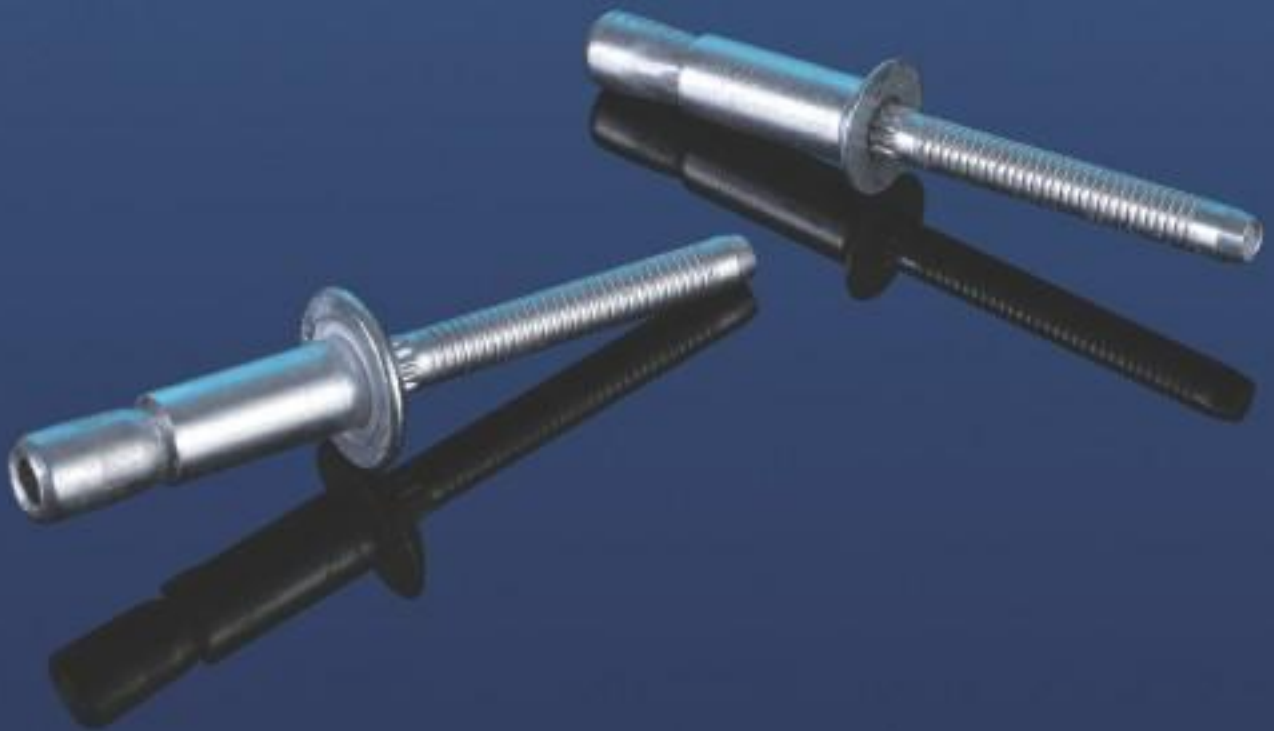

Aluminum Now-Lock Blind Rivet

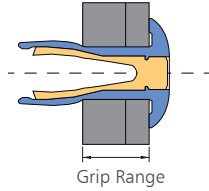
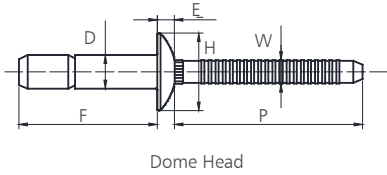

Material	Body	Aluminum
	Mandrel	Aluminum
Finish	Body	Natural
	Mandrel	Natural

*IPX-7 Watertightness Approved!

No.	Part Number	Size	Art. Code	D	E (Max)	F (Max)	H (Max)	P (Min)	W (Max)	Hole Dia	Grip Range	Tensile ref.	Shear ref.	Breaking Load (Max)	Retention load (Min)
1	AAN-48100	4.8x10	AAN-0604	Φ4.70 - Φ4.88	2.5	18.2	Φ10.2	27	3.1	Φ4.9 ~ Φ5.1	1.6 ~ 6.9	2225N	3115N	4200N	350N
2	AAN-48140	4.8x14	AAN-0607			24.6					1.6 ~ 11.0				
3	AAN-64140	6.4x14	AAN-0806	Φ6.40 - Φ6.58	3.1	25.3	Φ13.5	27	4.1	Φ6.7 ~ Φ6.9	2.1 ~ 9.5	3960N	5785N	7000N	450N
4	AAN-64190	6.4x19	AAN-0810			35.6					2.1 ~ 15.8				
5	AAN-98210	9.8x21	/	Φ9.70 Φ9.88	4.5	40.3	Φ20.5	35	6.2	Φ10.0 ~ Φ10.4	3.1 ~ 15.5	8100N	13300N	14000N	1200N

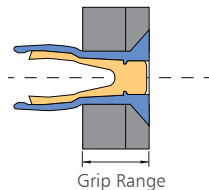
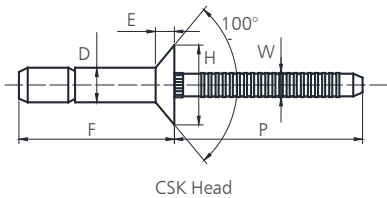

Material	Body	Aluminum
	Mandrel	Aluminum
Finish	Body	Natural
	Mandrel	Natural

*IPX-7 Watertightness Approved!

No.	Part Number	Size	Art. Code	D	E (Max)	F (Max)	H (Max)	P (Min)	W (Max)	Hole Dia	Grip Range	Tensile ref.	Shear ref.	Breaking Load (Max)	Retention load (Min)
1	AANC-48120	4.8x12	AANC-0606	Φ4.70 - Φ4.88	2.2	20.2	Φ9.2	27	3.1	Φ4.9 ~ Φ5.1	3.2 ~ 8.4	2225N	3115N	4200N	350N
2	AANC-48160	4.8x16	/			26.5					3.2 ~ 12.7				
3	AANC-64160	6.4x16	AANC-0808	Φ6.40 Φ6.58	2.4	28.3	Φ11.4	27	4.1	Φ6.7 ~ Φ6.9	4.3 ~ 12.1	3960N	5785N	7000N	450N
4	AANC-64220	6.4x22	/			36.5					4.3 ~ 18.4				

7.5 Aluminum Watertight Folding Rivet



7.5 Aluminum Watertight Folding Rivet

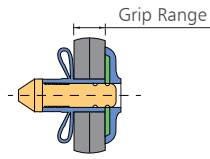
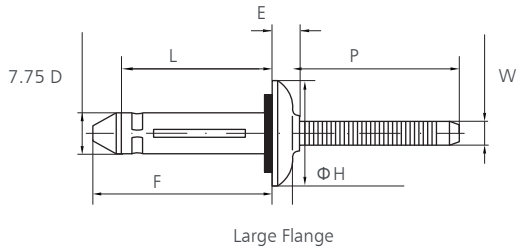

Body	AL5056
Mandrel	AL7A03
Washer	EPDM

No.	Art. Code	Part Number	Size	D (Max)	F (Max)	E (Max)	H (Max)	L (Max)	P (Min)	W (Max)	Hole Size	Grip Range	Tensile ref.	Shear ref.
1	AATFS6605-9-6W	AATFSLF7528019	7.5×28	Φ7.75	5.33	32.8	Φ19.4	28.2	25.4	4.5	Φ7.8 ~ Φ8.2	1.1 ~ 9.5	4400N	5600N
2	AATFS6605-9-10W	AATFSLF7534019	7.5×34			38.9		34.5				6.4 ~ 15.9		
3	AATFS6605-9-12W	AATFSLF7537019	7.5×37			42.1		37.7				9.5 ~ 19.1		

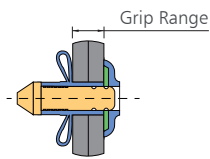
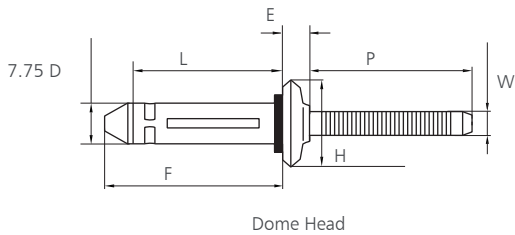

Body	AL5056
Mandrel	AL7A03
Washer	EPDM

No.	Art. Code	Part Number	Size	D (Max)	F (Max)	E (Max)	H (Max)	L (Max)	P (Min)	W (Max)	Hole Size	Grip Range	Tensile ref.	Shear ref.
1	AATFS6603-9-6W	AATFS75280	7.5×28	Φ7.75	4.83	32.8	Φ15.9	28.2	25.4	4.5	Φ7.8 ~ Φ8.2	0.8 ~ 9.5	4400N	5600N
2	AATFS6603-9-10W	AATFS75340	7.5×34			38.9		34.5				6.4 ~ 15.9		
3	AATFS6603-9-12W	AATFS75370	7.5×37			42.1		37.7				9.5 ~ 19.1		

5.2/6.4 Aluminum Watertight Folding Rivet



5.2/6.4 Aluminum Watertight Folding Rivet

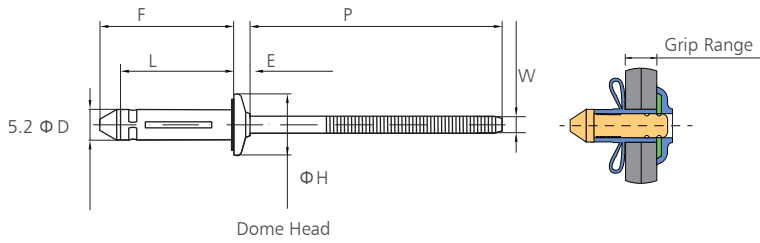

Body	AL5056
Mandrel	AL7A03
Washer	EPDM

No.	Art. Code	Part Number	Size	D (Max)	F (Max)	E (Max)	H (Max)	L (Max)	P (Min)	W (Max)	Hole Size	Grip Range	Tensile ref.	Shear ref.
1	AATFS6604-6-3W	AATFS52175	5.2x17.5	Φ5.2	3.4	20.9	Φ11.6	17.9	25.4	2.95	Φ5.3 ~ Φ5.5	1.3 ~ 4.8	1800N	2700N
2	AATFS6604-6-4W	AATFS52191	5.2x19.1			22.5		19.5				1.6 ~ 6.4		
3	AATFS6604-6-6W	AATFS52222	5.2x22.2			25.6		22.6				4.7 ~ 9.5		
4	AATFS6604-6-8W	AATFS52254	5.2x25.4			28.8		25.8				7.9 ~ 12.7		
5	AATFS6604-6-10W	AATFS52286	5.2x28.6			32.0		29.0				11.1 ~ 15.9		
6	AATFS6604-6-12W	AATFS52318	5.2x31.8			35.2		32.2				14.3 ~ 19.1		

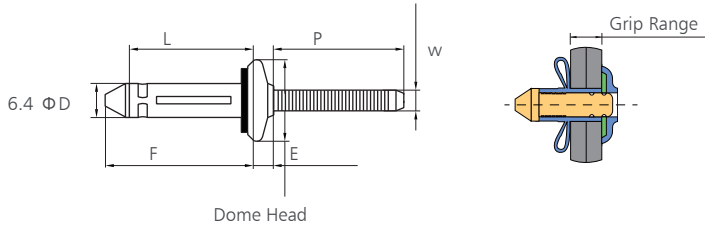

Body	AL5056
Mandrel	AL7A03
Washer	EPDM

No.	Art. Code	Part Number	Size	D (Max)	F (Max)	E (Max)	H (Max)	L (Max)	P (Min)	W (Max)	Hole Size	Grip Range	Tensile ref.	Shear ref.
1	AATFS6604-8-4W	AATFS64202	6.4x20.2	Φ6.39	4.0	25.5	Φ14.7	20.5	25.4	3.9	Φ6.4 ~ Φ6.6	1.6 ~ 6.4	2500N	3780N
2	AATFS6604-8-6W	AATFS64234	6.4x23.4			28.7		23.7				3.2 ~ 9.5		
3	AATFS6604-8-8W	AATFS64265	6.4x26.5			31.8		26.8				6.4 ~ 12.7		
4	AATFS6604-8-10W	AATFS64297	6.4x29.7			35.0		30.0				9.5 ~ 15.9		

Carbon Steel Boom-Lock Blind Rivet



Carbon Steel Boom-Lock Blind Rivet

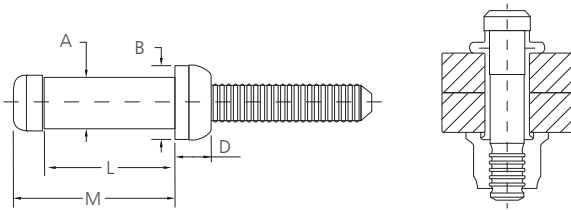







Material	Body	Alloy Steel
	Mandrel	High-carbon Steel
Finish	Body	Black Oxide
	Mandrel	Zinc Plated

*IPX-7 Watertightness Approved!

Part Number No.	Diameter mm	Art. Code	Grip Range		Drill Diameter		Φ A Max	Φ B Max	D Max	L Max	M Max	Shear Force (KN Nom)	Tensile Force (KN Nom)
			Min	Max	Min	Max							
SSBOOM48095	4.8 mm (3/16")	SSBOOM-00602	2.40	4.00	5.30	5.65	5.20	7.40	4.95	12.70	9.50	12.70	8.00
SSBOOM48111		SSBOOM-00603	4.00	5.60									
SSBOOM48127		SSBOOM-00604	5.60	7.20									
SSBOOM48143		SSBOOM-00605	7.80	8.80									
SSBOOM48159		SSBOOM-00606	8.80	10.30									
SSBOOM48175		SSBOOM-00607	10.30	11.90									
SSBOOM48190		SSBOOM-00608	11.90	13.50									
SSBOOM48206		SSBOOM-00609	13.50	15.10									
SSBOOM48222		SSBOOM-00610	15.10	16.70									
SSBOOM48238		SSBOOM-00611	16.70	18.30									
SSBOOM48254		SSBOOM-00612	18.30	19.90									
SSBOOM64116		6.4 mm (1/4")	SSBOOM-00802	2.80									
SSBOOM64132	SSBOOM-00803		4.00	5.60									
SSBOOM64148	SSBOOM-00804		5.60	7.20									
SSBOOM64164	SSBOOM-00805		7.20	8.80									
SSBOOM64180	SSBOOM-00806		8.80	10.30									
SSBOOM64196	SSBOOM-00807		10.30	11.90									
SSBOOM64212	SSBOOM-00808		11.90	13.50									
SSBOOM64228	SSBOOM-00809		13.50	15.10									
SSBOOM64243	SSBOOM-00810		15.10	16.70									
SSBOOM64259	SSBOOM-00811		16.70	18.30									
SSBOOM64275	SSBOOM-00812		18.30	19.90									

Carbon Steel Boom-Lock Blind Rivet

 Part Number <small>No.</small>	 Diameter <small>mm</small>	 Art. Code	 Grip Range		 Drill Diameter		ΦA <small>Max</small>	ΦB <small>Max</small>	D <small>Max</small>	L <small>Max</small>	M <small>Max</small>	 Shear Force <small>(KN Nom)</small>	 Tensile Force <small>(KN Nom)</small>
			Min	Max	Min	Max							
SSMBOOM80176	8.0 mm (5/16")	SSBOOM-01004	4.80	7.90	8.85	9.35	8.75	12.40	7.30	17.60	21.60	35.80	23.10
SSMBOOM80208		SSBOOM-01006	7.90	11.10						20.80	25.40		
SSMBOOM80240		SSBOOM-01008	11.10	14.30						24.00	28.60		
SSMBOOM80271		SSBOOM-01010	14.30	17.50						27.10	31.80		
SSMBOOM80303		SSBOOM-01012	17.50	20.60						30.30	34.90		
SSMBOOM80335		SSBOOM-01014	20.60	23.80						33.50	38.10		
SSMBOOM80367		SSBOOM-01016	23.80	27.00						36.70	41.30		
SSBOOM100194	10.0 mm (3/8")	SSBOOM-01204	4.80	7.90	10.50	11.05	10.45	14.70	8.30	19.40	24.60	49.40	32.30
SSBOOM100226		SSBOOM-01206	7.90	11.10						22.60	27.80		
SSBOOM100258		SSBOOM-01208	11.10	14.30						25.80	31.00		
SSBOOM100289		SSBOOM-01210	14.30	17.50						28.90	34.10		
SSBOOM100321		SSBOOM-01212	17.50	20.60						32.10	37.30		
SSBOOM100353		SSBOOM-01214	20.60	23.80						35.30	40.50		
SSBOOM100385		SSBOOM-01216	23.80	27.00						38.50	43.70		
SSBOOM100416		SSBOOM-01218	27.00	30.20						41.60	46.80		
SSBOOM100448		SSBOOM-01220	30.20	33.30						44.80	50.00		
SSBOOM127254	12.7 mm (1/2")	SSBOOM-01604	6.40	9.50	13.90	14.75	13.80	19.20	11.20	25.40	32.20	89.60	57.80
SSBOOM127285		SSBOOM-01606	9.50	12.70						28.50	35.30		
SSBOOM127317		SSBOOM-01608	12.70	15.90						31.70	38.50		
SSBOOM127349		SSBOOM-01610	15.90	19.10						34.90	41.70		
SSBOOM127381		SSBOOM-01612	19.10	22.20						38.10	44.90		
SSBOOM127412		SSBOOM-01614	22.20	25.40						41.20	48.00		
SSBOOM127444		SSBOOM-01616	25.40	28.60						44.40	51.20		
SSBOOM127476		SSBOOM-01618	28.60	31.80						47.60	54.00		
SSBOOM127508		SSBOOM-01620	31.80	34.90						50.80	57.60		
SSBOOM127539		SSBOOM-01622	34.90	38.10						53.90	60.70		
SSBOOM127571		SSBOOM-01624	38.10	41.30						57.10	63.90		

Carbon Steel Hem-Firm A Type Blind Rivet



Carbon Steel Hem-Firm A Type Blind Rivet

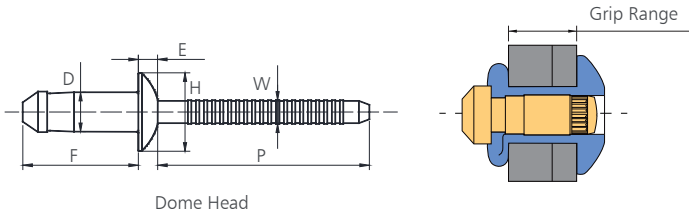

Material	Body	Carbon Steel 10B21
	Mandrel	Carbon Steel SWCH45K
Finish	Body	Zinc Plated
	Mandrel	Zinc Plated

*IPX-7 Watertightness Approved!

NO.	Part Number	Art. Code	Before Grip [F] (max)	Grip Range	Rivet Size (D)	Head Dia [H] (Max)	Head Height [E] (Max)	Mandrel Dia [W] (Max)	Mandrel Reveal [P] (Min)	Hole Dia	Typical Ultimate Strength			
											Tensile ref.	Shear ref.	Breaking Load (Max)	Retention load (Min)
1	SSH-A64090	SSH-A-0812	13.7	1.50 ~ 3.50	6.30 - 6.58	13.50	3.40	4.25	27.00	6.60 ~ 6.68	8800N	10500N	15000N	1800N
2	SSH-A64105	SSH-A-0813	15.0	2.80 ~ 4.80								12000N		
3	SSH-A64110	SSH-A-0814	15.6	3.50 ~ 5.35								12500N		
4	SSH-A64125	SSH-A-0815	17.0	4.80 ~ 6.80								14000N		
5	SSH-A64145	SSH-A-0817	19.0	6.80 ~ 8.80								15000N		
6	SSH-A64150	SSH-A-0818	19.7	7.50 ~ 9.50								16000N		
7	SSH-A64165	SSH-A-0819	21.0	8.80 ~ 10.80								16000N		
8	SSH-A64185	SSH-A-0821	23.0	10.80 ~ 12.80								16000N		
9	SSH-A64205	SSH-A-0823	25.2	12.80 ~ 14.80								16000N		
10	SSH-A64225	SSH-A-0825	27.2	14.80 ~ 16.80								16000N		
11	SSH-A64245	SSH-A-0827	29.5	16.80 ~ 18.80								16000N		
12	SSH-A64265	SSH-A-0829	31.5	18.80 ~ 20.80								16000N		

Carbon Steel Hem-Firm B Type Blind Rivet



Carbon Steel Hem-Firm B Type Blind Rivet

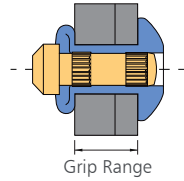
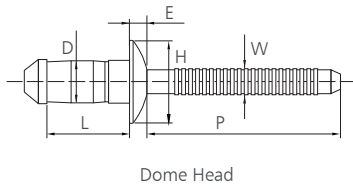

Material	Body	Carbon Steel 10B21
	Mandrel	Carbon Steel SWCH45K
Finish	Body	Zinc Plated
	Mandrel	Zinc Plated

*IPX-7 Watertightness Approved!

NO.	Part Number	Art. Code	L (max)	Grip Range	Rivet Size (D)	Head Dia [H] (Max)	Head Height [E] (Max)	Mandrel Dia [W] (Max)	Mandrel Reveal [P] (Min)	Hole Dia	Typical Ultimate Strength			
											Tensile ref.	Shear ref.	Breaking Load (Max)	Retention load (Min)
1	SSH-B48090	L48090P	9.00	1.50~3.50	4.8	10.20	2.50	3.40	27.00	4.90~5.10	4400N	6000N	9000N	1000N
2	SSH-B48115	L48115P	11.50	3.50~6.00								7500N		
3	SSH-B48140	L48140P	14.00	6.00~8.50								7800N		
4	SSH-B48165	L48165P	16.50	8.50~11.00										
5	SSH-B48190	L48190P	19.00	11.00~13.50										
6	SSH-B64090	L64090P	9.00	1.50~3.50	6.4	13.40	3.50	4.20	27.00	6.60~6.80	7920N	7700N	15000N	1800N
7	SSH-B64105	L64105P	10.50	2.00~4.50								9450N		
8	SSH-B64125	L64125P	12.50	3.50~6.50								10800N		
9	SSH-B64145	L64145P	14.50	5.50~8.50										
10	SSH-B64165	L64165P	16.50	7.50~10.50										
11	SSH-B64185	L64185P	18.50	9.50~12.50										
12	SSH-B64205	L64205P	20.50	11.00~14.00										
13	SSH-B64225	L64225P	22.50	13.00~16.00										
14	SSH-B64245	L64245P	24.50	14.50~18.00										
15	SSH-B64265	L64265P	26.50	16.50~20.00										
16	SSH-B64285	L64285P	28.50	18.50~22.00										
17	SSH-B64305	L64305P	30.50	20.50~24.00										
18	SSH-B64325	L64325P	32.50	22.50~26.00										
19	SSH-B78135	L78135P	13.50	4.00~7.00	7.8	18.00	4.20	5.20	27.00	8.10~8.30	11500N	15500N	23000N	2500N
20	SSH-B78165	L78165P	16.50	7.00~10.00								18000N		
21	SSH-B78195	L78195P	19.50	10.00~13.00										
22	SSH-B78225	L78225P	22.50	13.00~16.00										

Carbon Steel Mono-Lock Blind Rivet



Carbon Steel Mono-Lock Blind Rivet

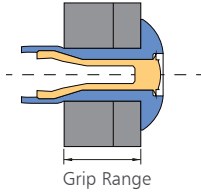
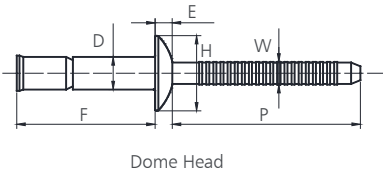

Material	Body	Carbon Steel 10B21
	Mandrel	Carbon Steel SWCH45K
Finish	Body	Zinc Plated
	Mandrel	Zinc Plated

*IPX-7 Watertightness Approved!

No.	Part Number	Size	Art. Code	D	E (Max)	F (Max)	H (Max)	P (Min)	W (Max)	Hole Dia	Grip Range	Tensile ref.	Shear ref.	Breaking Load (Max)	Retention load (Min)
1	SSM-AVD48100	4.8×10	SSM-AVD0613	Φ4.70 - Φ4.88	2.1	18.2	Φ10.1	27	3.1	Φ4.9 ~ Φ5.1	1.6 ~ 6.9	5110N	6440N	7500N	600N
2	SSM-AVD48140	4.8×14	SSM-AVD0617			24.5					1.6 ~ 11.0				
3	SSM-AVD64140	6.4×14	SSM-AVD0817	Φ6.40 - Φ6.58	2.9	23.7	Φ13.4	27	4.1	Φ6.7 ~ Φ7.0	2.1 ~ 9.5	10450N	11780N	12500N	1100N
4	SSM-AVD64190	6.4×19	SSM-AVD0824			33.0					2.1 ~ 15.8				

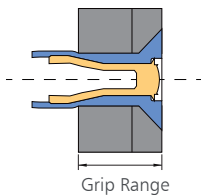
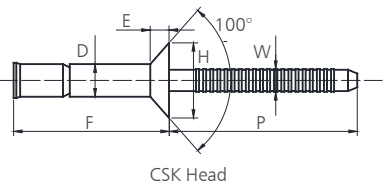

Material	Body	Carbon Steel 10B21
	Mandrel	Carbon Steel SWCH45K
Finish	Body	Zinc Plated
	Mandrel	Zinc Plated

*IPX-7 Watertightness Approved!

No.	Part Number	Size	Art. Code	D	E (Max)	F (Max)	H (Max)	P (Min)	W (Max)	Hole Dia	Grip Range	Tensile ref.	Shear ref.	Breaking Load (Max)	Retention load (Min)
1	SSMC-AVD48120	4.8×12	SSMC-AVD0615	Φ4.70 - Φ4.88	2.2	20	Φ8.8	27	3.1	Φ4.9 ~ Φ5.1	3.2 ~ 8.3	5110N	6440N	7500N	600N
2	SSMC-AVD48160	4.8×16	SSMC-AVD0619			26.5					3.2 ~ 12.2				
3	SSMC-AVD64160	6.4×16	SSMC-AVD0821	Φ6.40 - Φ6.58	2.4	26.3	Φ10.1	27	4.1	Φ6.7 ~ Φ7.0	3.2 ~ 12.1	10450N	11780N	12500N	1100N
4	SSMC-AVD64220	6.4×22	/			34.5					3.2 ~ 16.0				

Carbon Steel Multi-Grip Blind Rivet



Carbon Steel Multi-grip Blind Rivet

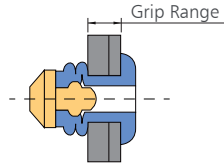
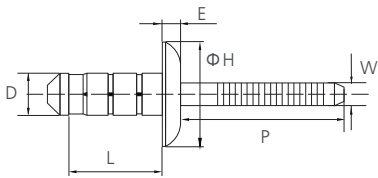

Material	Body	Carbon Steel
	Mandrel	Carbon Steel
Finish	Body	Zinc Plated
	Mandrel	Zinc Plated

D	Part Number	L [+1/-0]	Grip Range	H	E (Max)	Drill	P (Min)	W (Max)	Shear [N] (Min)	Tensile [N] (Min)
3.2 +0.08 -0.15	SSMG32080	8.00	1.0-4.0	6.70	1.3	3.3-3.4	27	2.25	1000	1200
	SSMG32100	10.00	2.5-6.0							
	SSMG32120	12.00	1.5-8.0							
	SSMG32140	14.00	3.5-9.5							
	SSMG32160	16.00	5.5-11.5							
4.0 +0.08 -0.15	SSMG40080	8.00	1.0-3.5	8.40	1.70	4.10-4.20	27	2.85	1500	2000
	SSMG40100	10.00	1.5-5.0							
	SSMG40120	12.00	3.5-7.0							
	SSMG40140	14.00	1.5-9.0							
	SSMG40160	16.00	3.5-11.0							
	SSMG40180	18.00	5.5-12.5							
	SSMG40200	20.00	7.5-14.5							
4.8 +0.08 -0.15	SSMG48100	10.00	1.5-4.5	10.10	2.00	4.90-5.00	27	3.35	2400	2900
	SSMG48120	12.00	2.0-6.5							
	SSMG48140	14.00	3.0-8.5							
	SSMG48160	16.00	3.0-10.5							
	SSMG48180	18.00	5.0-12.5							
	SSMG48200	20.00	7.0-14.5							
	SSMG48220	22.00	9.0-16.5							
	SSMG48250	25.00	11.0-19.0							
	SSMG48270	27.00	13.0-21.0							
	SSMG48300	30.00	16.0-24.0							
6.4 +0.08 -0.15	SSMG64125	12.50	1.0-6.0	13.40	2.70	6.50-6.60	27	4.15	3800	4000
	SSMG64145	14.50	1.5-7.5							
	SSMG64165	16.50	2.0-9.0							
	SSMG64185	18.50	4.0-11.0							
	SSMG64205	20.50	5.5-12.5							
	SSMG64255	25.50	10.5-17.5							

Carbon Steel Now-Lock Blind Rivet



Carbon Steel Now-Lock Blind Rivet

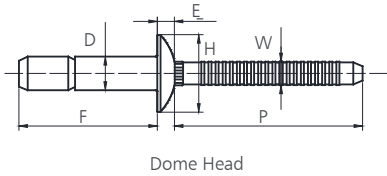

Dome Head

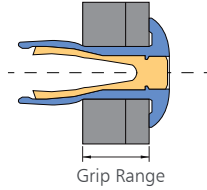

Grip Range

Material	Body	Carbon Steel 10B21
	Mandrel	Carbon Steel SWCH45K
Finish	Body	Zinc Plated
	Mandrel	Zinc Plated

*IPX-7 Watertightness Approved!

No.	Part Number	Size	Art. Code	D	E (Max)	F (Max)	H (Max)	P (Min)	W (Max)	Hole Dia	Grip Range	Tensile ref.	Shear ref.	Breaking Load (Max)	Retention load (Min)
1	SSN-AVD48100	4.8x10	SSN-AVD0604	Φ4.70 - Φ4.88	2.5	18.2	Φ10.2	27	3.1	Φ4.9~ Φ5.1	1.6 ~ 6.9	5340N	6452N	8500N	1000N
2	SSN-AVD48140	4.8x14	SSN-AVD0607			24.6					1.6 ~ 11				
3	SSN-AVD64140	6.4x14	SSN-AVD0806	Φ6.40 - Φ6.58	3.1	25.3	Φ13.5	27	4.1	Φ6.7 ~ Φ6.9	2.1 ~ 9.5	9790N	12237N	15000N	1800N
4	SSN-AVD64190	6.4x19	SSN-AVD0810			35.6					2.1 ~ 15.8				
5	SSN-AVD98210	9.8x21	SSN-AVD1210	Φ9.70 Φ9.88	4.5	40.3	Φ20.5	35	6.2	Φ10.0~Φ10.4	3.1 ~ 15.5	17700N	26600N	32000N	2500N

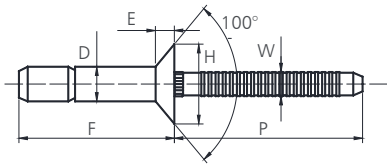

CSK Head

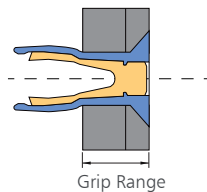

Grip Range

Material	Body	Carbon Steel 10B21
	Mandrel	Carbon Steel SWCH45K
Finish	Body	Zinc Plated
	Mandrel	Zinc Plated

*IPX-7 Watertightness Approved!

No.	Part Number	Size	Art. Code	D	E (Max)	F (Max)	H (Max)	P (Min)	W (Max)	Hole Dia	Grip Range	Tensile ref.	Shear ref.	Breaking Load (Max)	Retention load (Min)
1	SSNC-AVD48120	4.8x12	SSNC-AVD0606	Φ4.70 - Φ4.88	2.1	20.2	Φ9.2	27	3.1	Φ4.9~ Φ5.1	3.2 ~ 8.4	5340N	6452N	8500N	1000N
2	SSNC-AVD48160	4.8x16	/			26.5					3.2 ~ 12.7				
3	SSNC-AVD64160	6.4x16	SSNC-AVD0808	Φ6.40 - Φ6.58	2.3	28.3	Φ11.4	27	4.1	Φ6.7 ~ Φ6.9	4.3 ~ 12.1	9790N	12237N	15000N	1800N
4	SSNC-AVD64220	6.4x22	/			36.5					4.3 ~ 18.4				
5	SSNC-AVD98260	9.8x26	/	Φ9.70 Φ9.88	3.7	45.0	Φ16.5	35	6.2	Φ10.0~Φ10.4	6.1 ~ 19.0	15500N	25000N	32000N	2500N

Carbon Steel Self Piercing Rivet

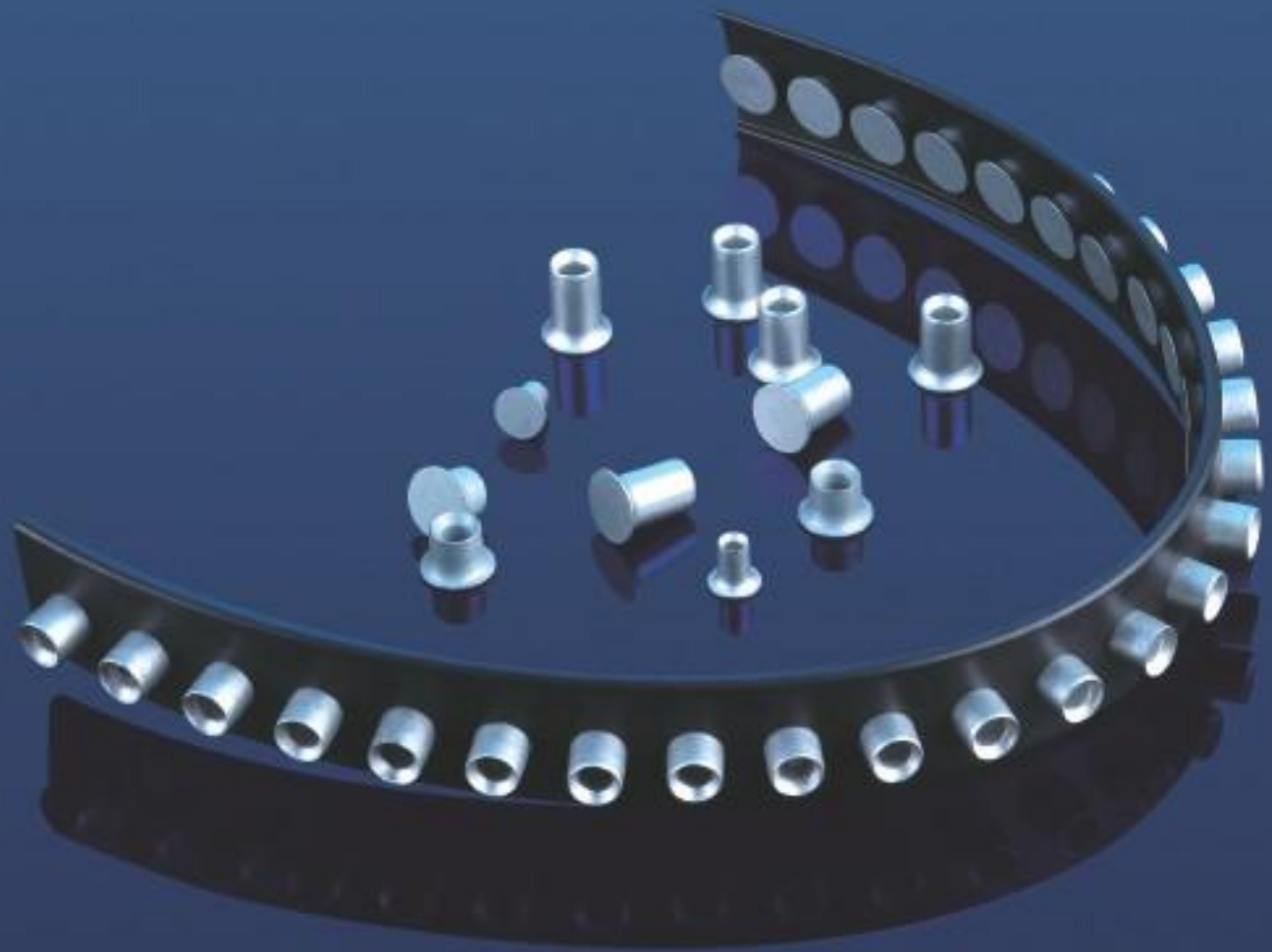

Carbon Steel Self Piercing Rivet

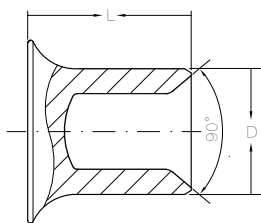

“C”, “J”, “K” Series
Fully Radiused CSK "A" Style

Material	Medium-Carbon Steel
Finish	Zinc Plating or Almac Coating

No.	Part Number	Size	D	L	Applicable Products (unit mm)	Quantity
01	SSPRA53040	5.3*4	5.3	4	0.8+1 (Steel or aluminum)	5000 Only / disk
02	SSPRA53050	5.3*5	5.3	5	0.8+1 (Steel or aluminum)/ 1+1.5 (Steel or aluminum)	5000 Only / disk
03	SSPRA53055	5.3*5.5	5.3	5.5	1+1 (Steel or aluminum)/ 1+1.5 (Steel or aluminum)/ 1.5+1.5 (Steel or aluminum)	5000 Only / disk
04	SSPRA53060	5.3*6	5.3	6	1.5+1.5 (Steel or aluminum)/ 1.5+2 (Steel or aluminum)	5000 Only / disk
05	SSPRA53065	5.3*6.5	5.3	6.5	1.5+2 (Steel or aluminum)/ 1.5+2.5 (Steel or aluminum)/ 2+2 (Steel or aluminum)	5000 Only / disk
06	SSPRA53070	5.3*7	5.3	7	2+2.5 (Steel or aluminum)/ 1.5+2.5 (Steel or aluminum)/ 2+2 (Steel or aluminum)	5000 Only / disk
07	SSPRA53075	5.3*7.5	5.3	7.5	1.5+2.5 (Steel or aluminum)/ 2.5+2.5 (Steel or aluminum)/ 2+2 (Steel or aluminum)	5000 Only / disk
08	SSPRA53080	5.3*8	5.3	8	2.5+2.5 (Steel or aluminum)/ 2.5+3 (Steel or aluminum)	5000 Only / disk
09	SSPRA53090	5.3*9	5.3	9	3+3 (Steel or aluminum)/ 3+3.5 (Steel or aluminum)	5000 Only / disk
10	SSPRA53100	5.3*10	5.3	10	3+4 (Steel or aluminum)/ 3+4.5 (Steel or aluminum)	5000 Only / disk
11	SSPRA53120	5.3*12	5.3	12	5+5 (Steel or aluminum)/ 4.5+4.5 (Steel or aluminum)	4000 Only / disk
12	SSPRA33035	3.3*3.5	3.3	3.5	1+1 (Steel or aluminum)	10000 Only / disk
13	SSPRA33040	3.3*4	3.3	4	1+1 (Steel or aluminum)	10000 Only / disk
14	SSPRA33050	3.3*5	3.3	5	1+1 (Steel or aluminum)/ 1+1.5 (Steel or aluminum)/ 1.5+1.5 (Steel or aluminum)	10000 Only / disk
15	SSPRA33060	3.3*6	3.3	6	1.5+1.5 (Steel or aluminum)/ 1.5+2 (Steel or aluminum)	10000 Only / disk

Carbon Steel Uni-Grip Blind Rivet

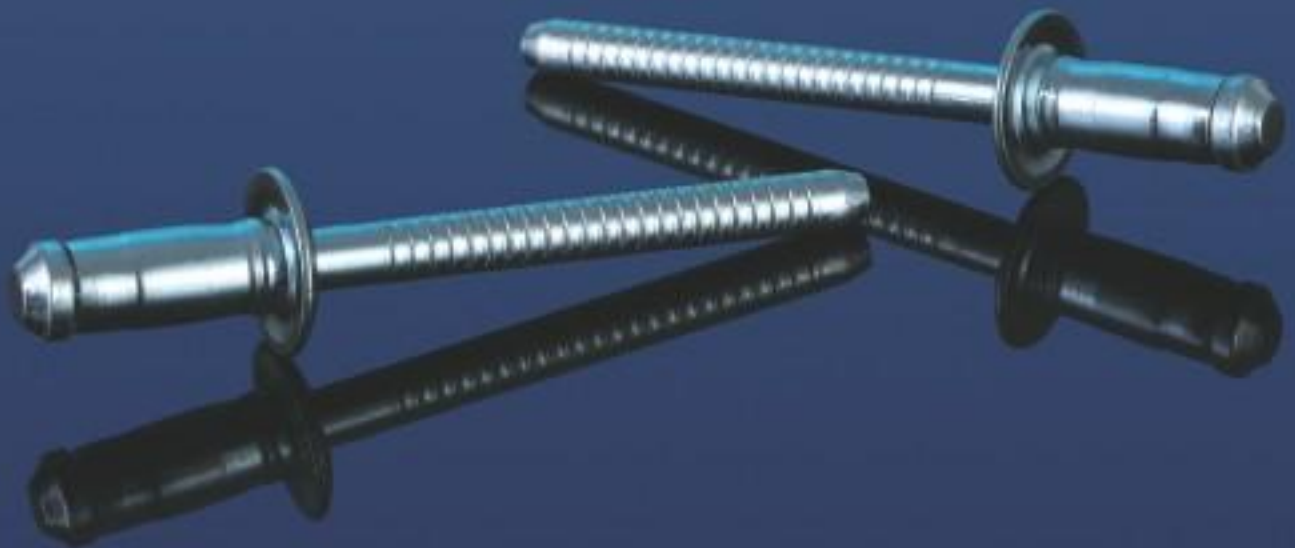

Carbon Steel Uni-grip Blind Rivet

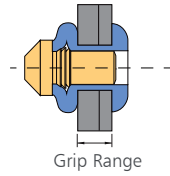
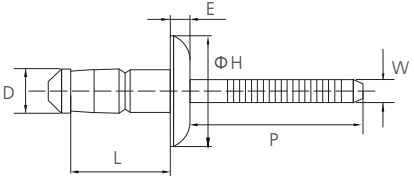

Material	Body	Carbon Steel 10B21
	Mandrel	Carbon Steel 42A
Finish	Body	Zinc Plated
	Mandrel	Zinc Plated

D	Part Number	Art. Code	L [+1/-0]	Grip Range	H	E (Max)	Drill	P (Min)	W (Max)	Shear [N] (Min)	Tensile [N] (Min)
3.2 +0.08 -0.15	SSPMG32065	SSPMG-0408	6.5	1.0-3.0	5.5-6.8	1.4	3.3-3.4	27	2.10	1200	1300
	SSPMG32080	/	8.0	2.0-4.0						1700	
	SSPMG32092	SSPMG0411	9.2	3.0-5.0							
	SSPMG32115	SSPMG0414	11.5	5.0-7.0							
4.0 +0.08 -0.15	SSPMG40075	SSPMG-0509	7.5	1.0-3.0	7.3-8.3	1.6	4.1-4.2	27	2.70	2000	2800
	SSPMG40085	/	8.5	2.0-4.5						3500	
	SSPMG40095	SSPMG-0512	9.5	3.0-5.0							
	SSPMG40125	SSPMG-0516	12.5	5.0-7.0							
4.8 +0.08 -0.15	SSPMG48100	SSPMG-0611	10.0	1.5-3.5	9.0-10.0	1.7	4.9-5.0	27	3.20	3600	3800
	SSPMG48120	SSPMG-0614	12.0	3.5-6.0						4200	
	SSPMG48143	SSPMG-0618	14.3	6.0-8.5							
	SSPMG48160	/	16.0	7.0-10.0							
	SSPMG48180	/	18.0	9.5-12.0							
6.0 +0.08 -0.15	SSPMG60100	SSPMG-6010	10.0	1.5-4.0	11.0-12.3	2.15	6.1-6.2	31	4.10	4200	5400
	SSPMG60130	SSPMG-6013	13.0	3.0-6.0						5900	
	SSPMG60160	SSPMG-6016	16.0	6.0-9.0							
	SSPMG60190	SSPMG-6019	19.0	9.0-12.0							

Stainless Steel Mono-Lock Blind Rivet

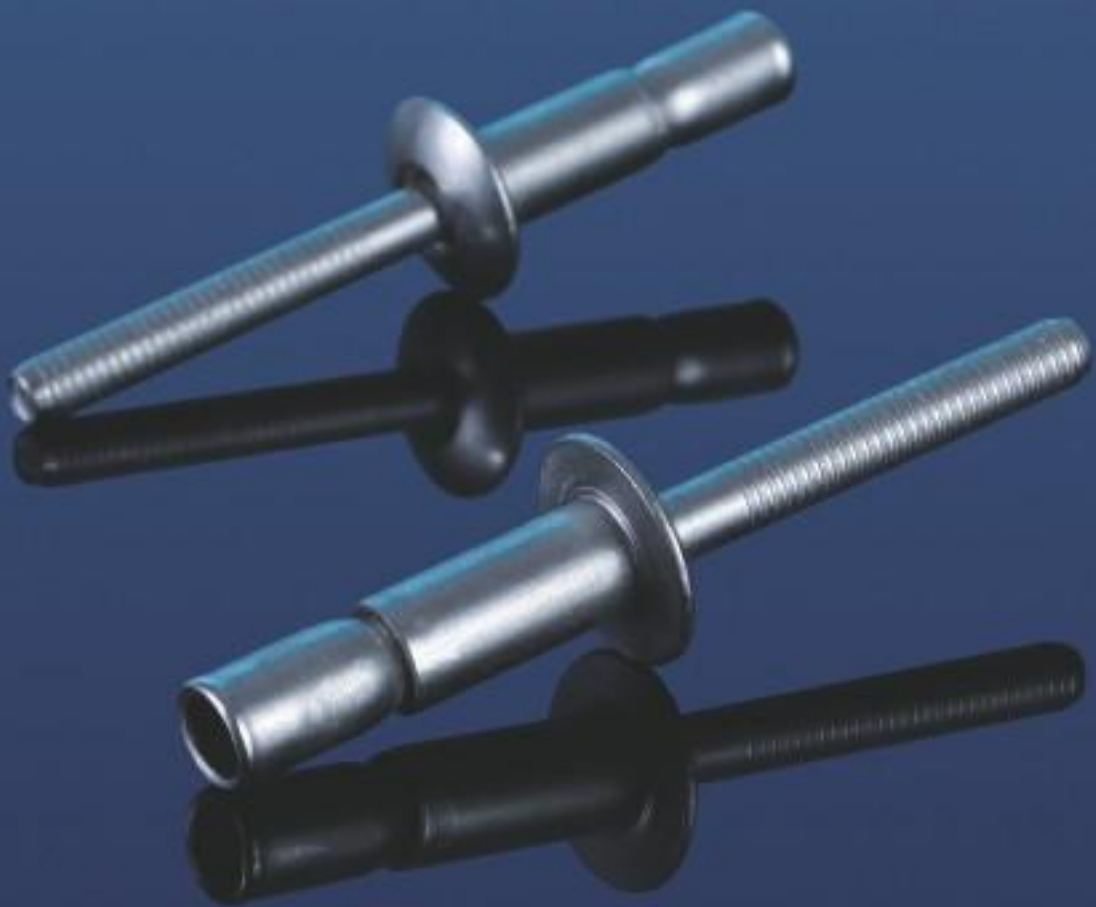

Stainless Steel Mono-Lock Blind Rivet

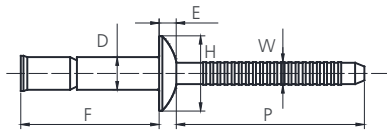

Dome Head

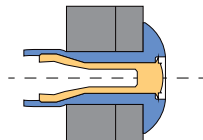

Grip Range

Material	Body	304 Stainless Steel
	Mandrel	304/302 Stainless Steel
Finish	Body	Polished
	Mandrel	Polished

*IPX-7 Watertightness Approved!

No.	Part Number	Size	Art. Code	D	E (Max)	F (Max)	H (Max)	P (Min)	W (Max)	Hole Dia	Grip Range	Tensile ref.	Shear ref.	Breaking Load (Max)	Retention load (Min)
1	BBM48100	4.8×10	BBM0613	Φ4.8	2.2	18.2	Φ10.1	27	3.1	Φ4.9 ~ Φ5.1	1.6 ~ 6.5	5100N	6400N	7000N	445N
2	BBM48140	4.8×14	BBM0617			24.4					1.6 ~ 11.0				
3	BBM64140	6.4×14	BBM0817	Φ6.4	3.0	26.7	Φ13.4	27	4.1	Φ6.7 ~ Φ7.0	2.1 ~ 9.5	9000N	11000N	12000N	1112N
4	BBM64190	6.4×19	BBM0824			36.5					2.1 ~ 16.0				
5	BBM98210	9.8×21	BBM01228	Φ9.8	4.0	36.2	Φ20.0	27	6.15	Φ10.0 ~ Φ10.4	3.0 ~ 16.0	19400N	26080N	20000N	2400N

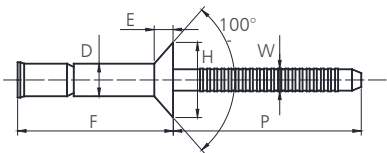

Csk Head

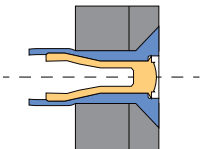

Grip Range

Material	Body	304 Stainless Steel
	Mandrel	304/302 Stainless Steel
Finish	Body	Polished
	Mandrel	Polished

*IPX-7 Watertightness Approved!

No.	Part Number	Size	Art. Code	D	E (Max)	F (Max)	H (Max)	P (Min)	W (Max)	Hole Dia	Grip Range	Tensile ref.	Shear ref.	Breaking Load (Max)	Retention load (Min)
1	BBMC48120	4.8×12	BBM0615	Φ4.8	2.2	20.2	Φ9.0	27	3.1	Φ4.9 ~ Φ5.1	3.2 ~ 8.4	5100N	6400N	7000N	445N
2	BBMC48160	4.8×16	/			26.5					3.2 ~ 12.7				
3	BBMC64160	6.4×16	BBM0821	Φ6.4	2.4	28.3	Φ10.5	27	4.1	Φ6.7 ~ Φ7.0	4.1 ~ 12.1	9000N	11000N	12000N	1112N
4	BBMC64220	6.4×22	/			37.6					4.1 ~ 17.5				